

# Gorillo Pro Hand Dryer

## User Manual

Gorillo Pro - 1001 • 1002

**handydryers**

**HandyDryers**  
Unit 9, Stort Valley Industrial Estate  
Stansted Road, Bishop's Stortford  
Hertfordshire, United Kingdom  
CM23 2TU

**www.handydryers.co.uk**  
**01279 466500**  
**info@handydryers.co.uk**

# Contents

- Features . . . . . 3
- Warning . . . . . 4
- Product diagram . . . . . 5
- Usage . . . . . 6
- Routine Cleaning . . . . . 7
- Cleaning the air filter . . . . . 8
- Trouble shooting / electrical schematic . . . . . 9
- Precautions before installing . . . . . 10
- Installation Procedures . . . . . 12
- Customer Service . . . . . 16

The new Gorillo is not only a sleek hands-in blade dryer but also highly economical using less energy and keeping running costs low while offering exceptional durability. The two high-speed airstreams force water from your hands to give you convenient and hygienic drying without the need to touch any surfaces.

This unit is suitable for most public places including restaurants, office buildings, factories, supermarkets, hospitals and almost all public conveniences.

**Simple to use:**

- Insert both hands face down, fingers apart.
- After a few seconds, slowly remove hands and repeat process until dry.

## Features

- Internal HEPA filter as standard (check): Cleans the air whilst drying your hands
- Brushless High Efficiency Motor: 10 - 12 second dry time:
- In built digital room thermometer: Self Adjusting air heat output for greater efficiency
- Great looks with waste water collection: no more wet floors
- Lowest noise output in sector: Only 73dB
- Anti-damage timer turns the unit off when not in use. After 25 seconds, draw out your hands and put your hands into the dryer to continue use.
- Reduces use of costly towels, tissues and waste
- Anti-bacterial & environmental materials
- Automatic heating, dries hands more comfortably in winter

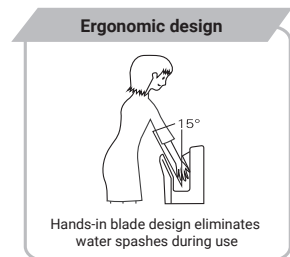
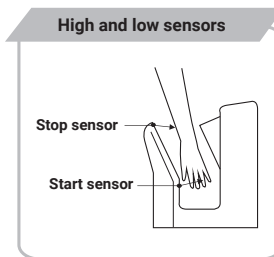
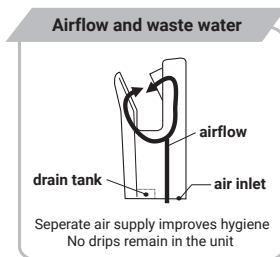

## Warning

1. **DO NOT** open the front panel, this can lead to an electric shock.
2. **DO NOT** let children hang on the machine.
3. **DO NOT** allow the unit to get wet. This will cause electric shock.
4. **DO NOT** modify and disassemble the unit unnecessarily. This may cause a fire, electric shock, or personal injury.
5. Rated power is required.
6. **If power tolerance is over +/-10%, the unit will malfunction. If incorrect power supply is used there is a risk of fire, electric shock and machine malfunction.**
7. Drain tank and air filter must be installed before switching the power on.
8. If the unit doesn't work or needs troubleshooting, please cut off the power to prevent any accident; switch off the circuit breaker and ask supplier to check and repair the unit if necessary. Failure to check may lead to fire because of electricity leakage or short circuit.

### Attention when installing:

9. **DO NOT** install when the machine is connected to the power supply.
10. Installation must be completed by a qualified electrician.
11. If the cord is damaged, it must be replaced by the manufacturer, a recommended service agent or similarly qualified persons in order to avoid a hazard.
12. For additional protection, the installation of a residual current device (RCD) having a rated residual operating current not exceeding 30mA is advisable in the electrical circuit supplying the bathroom. Ask your installer for advice.
13. This appliance is not intended for use by persons (including children) with reduced physical, sensory or mental capabilities, unless they are supervised and instructed how to use the appliance by the person responsible for their safety.

# Product diagram

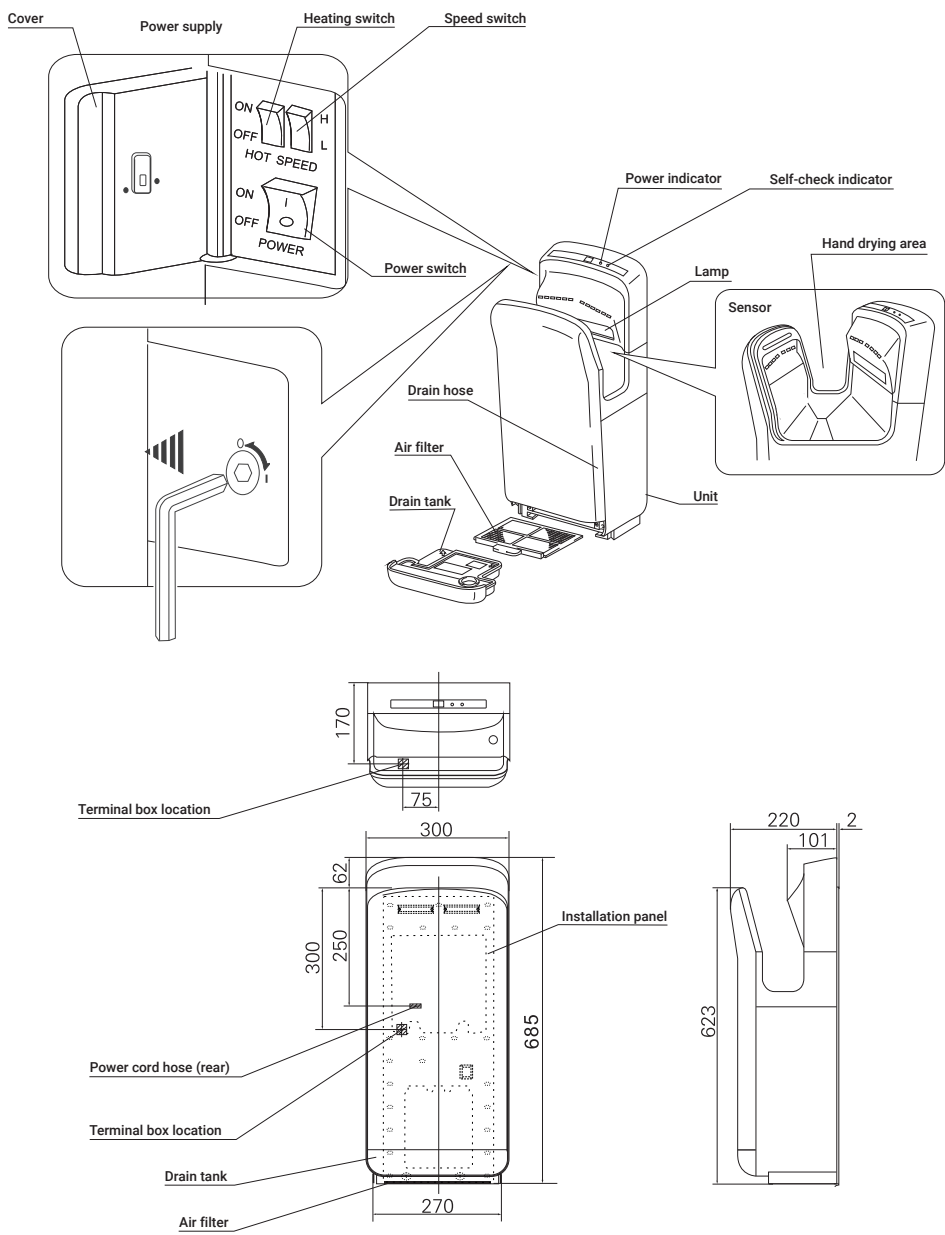

# Usage

## Using the unit

- Stretch out both hands and insert them into the opening of the hand dryer. The unit will start when the start sensor is activated.
- Pull them out slowly, letting the air blow the water off.
- Repeat until hands are completely dry. Pull them out completely.



## Self-check indicator

- When a malfunction or error occurs, the self-check indicator on the right side will either light up or flash.
- Turn off the power switch, wait 40 seconds until all the indicators go off, turn on the power switch.
- If the indicator still lights up or flashes, turn off the power, disconnect the unit from the socket, and contact your dealer immediately.

## Usage Label

When using the unit, turn on the power switch.

- The power indicator and lamp light up.
- The power supply cover should be closed.
- Attach the usage label where applicable.



# Routine Cleaning

- Always clean the unit with a soft cloth
- If the unit gets very dirty, clean with a soft cloth dampened with neutral agent, then clean with a dry soft cloth.
- Remove any dirt from the sensor. (to prevent malfunction).

## Warning

- Before cleaning the unit, turn off the power switch.
- Do not splash excessive water on the unit.

## Caution

- Wear gloves when cleaning.
- The antibacterial coating is effective when bacteria is exposed on the coated surfaces
- The antibacterial coating becomes ineffective when the surfaces get very dirty.

## Drain and clean the drain tank

- Drain the tank before it fills up or at least once a week
- Water blown off the hands is called drain water.
- Regularly empty the waste water in order to prevent accumulated water from exceeding the fill level.
- Collected waste water will start to smell if the accumulated water remains in the tank for too long.

### Part 1

- Pull the drain tank out in a horizontal direction, this ensures the drain water does not splash out.

### Part 2

1. Open the cover and empty the water. Pull the cover up with your fingers in the direction of the arrow on top of the cover, and then remove the cover completely.
  2. Wash out the interior of the drain tank
  3. Close the water tank cover and re-attach it to the unit in the original position.
- Confirm all parts are firmly inserted.

### Part 3

- Add 200cc (around 1 cup of water through the drain hole to wash through and prevent it from getting clogged).
- Resume use of the unit after confirming the water tank is in place.

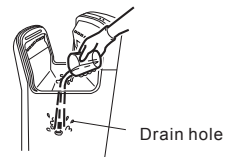
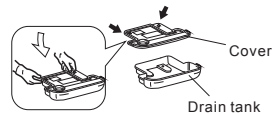
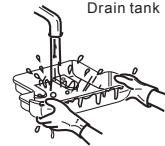
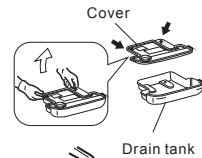
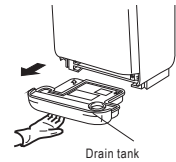

# Cleaning the air filter

Around once a week

## Part 1

- Remove air filter
- Pull the air filter out by the handle

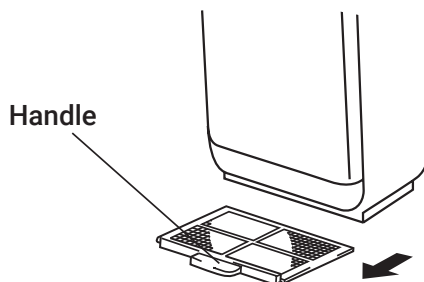

## Part 2

1. Cleaning the air filter
  - Beat it lightly by hand or use vacuum cleaner.
  - If it is very dirty, wash it off with cold or warm water.
2. Re-attach to the unit.
  - Insert it all the way in, until it stops. (If it is not in place, the dirt or dust will enter the unit and shorten its life or cause it to malfunction.)

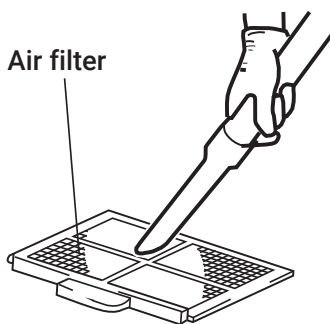

---

### Note

- If you wash the air filter with water, ensure it is completely dry before inserting it back into the unit.
- Do not expose the air filter to excessive heat or fire.



# Trouble shooting / electrical schematic

Problem	Check	Action
No air blows after hands are inserted	<ul style="list-style-type: none"> <li>Do the display indicators light up?</li> <li>Is the power switch on?</li> <li>Are you putting hands all the way in?</li> </ul>	<ul style="list-style-type: none"> <li>Turn the circuit breaker on</li> <li>Turn the power switch on</li> <li>Put hands all the way in</li> </ul>
Machine works for a long time after hands drawn out	<ul style="list-style-type: none"> <li>Check for any foreign objects obstructing the sensor?</li> </ul>	Switch off the power button, remove dirt or foreign objects obstructing the sensor after the power light goes out. When complete, switch on power button.
Air coming from the dryer is not hot	<ul style="list-style-type: none"> <li>Is the heating switch turned on?</li> </ul>	Turn on the heating switch
Airflow is too low	<ul style="list-style-type: none"> <li>Is the speed button on low level?</li> </ul>	Put the speed button on the high level
If the above actions do not work, turn off the power and the circuit breaker. Call your authorised electrician to inspect and repair the unit. If necessary contact the supplying retailer for further diagnosis and repair as per the supplying terms and conditions or any warranty supplied with the unit.		

## Electrical Schematic

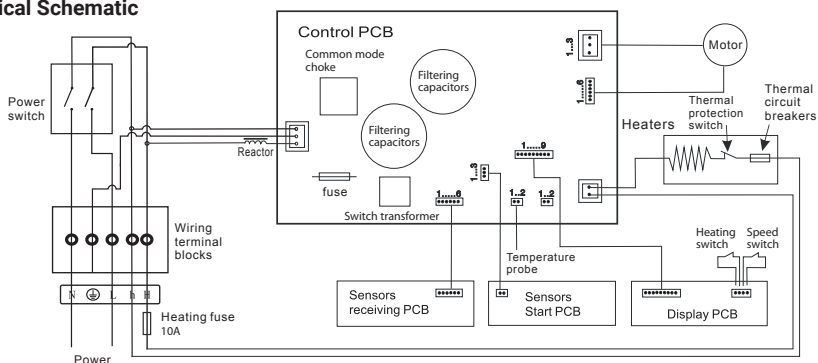

	Status	Indicator	Status	Indicator	Solution
Power indicator light	Lit	Power input normal	Extinguished	No power supply	Check the external power source, close the power switch
				Master board fuse blown	Replace fuse
State indicator light	Extinguished	No working	Flashing light	Motor fault, won't start normally	Check motor connecting wires and no foreign material is obstructing the rotor
	Always lit	Working		Working time longer than 25s	Clear foreign material from the unit
Timing digital tube	Digital dial changes	Countdown is working correctly	Display jumps to	Indicates drying time finished	
	E1	Motor fault, won't start normally	E2	Working time longer than 25s	Clear foreign material from the unit
	E3	Voltage exceeds 15% tolerance	E4	Voltage is than 15% tolerance	Check the power supply circuit
	E5	Machine temperatures higher than 80°C	E6	Master board temperatures higher than 80°C	Clear any foreign material from the air inlet and outlet
			E8	Fan fault	Check the fan sensor connection

# Precautions before installing

DO NOT install in the following types of location, this may cause malfunction:

- Locations where the temperature can exceed -10°C or 40°C
- Locations where the unit may come into direct contact with water
- Locations where the unit is under direct or strong sunlight
- Locations where there is a lot of condensation
- Locations where corrosive, neutral or reductive gases are present
- Places lower than -20m or higher than 2000m above sea level

## Installation location

- Install somewhere the unit will be easy to use.
- If the unit is installed too low, water splashes may get on it when the floor is cleaned. (The bottom of the unit must be at least 150mm higher than the floor or any objects under it.)
- The left side of the unit must be at least 150mm away from any walls leaving room for the power switch which is located on the left.
- Ensure there are no mirrors or walls near the right side as drops of water may splatter to the right of the unit when drying hands. (Recommended distance is at least 100mm.)
- Avoid locations where people or doors can bump into the unit.
- Choose a completely flat surface on the wall to install the unit.

# Installation Diagram

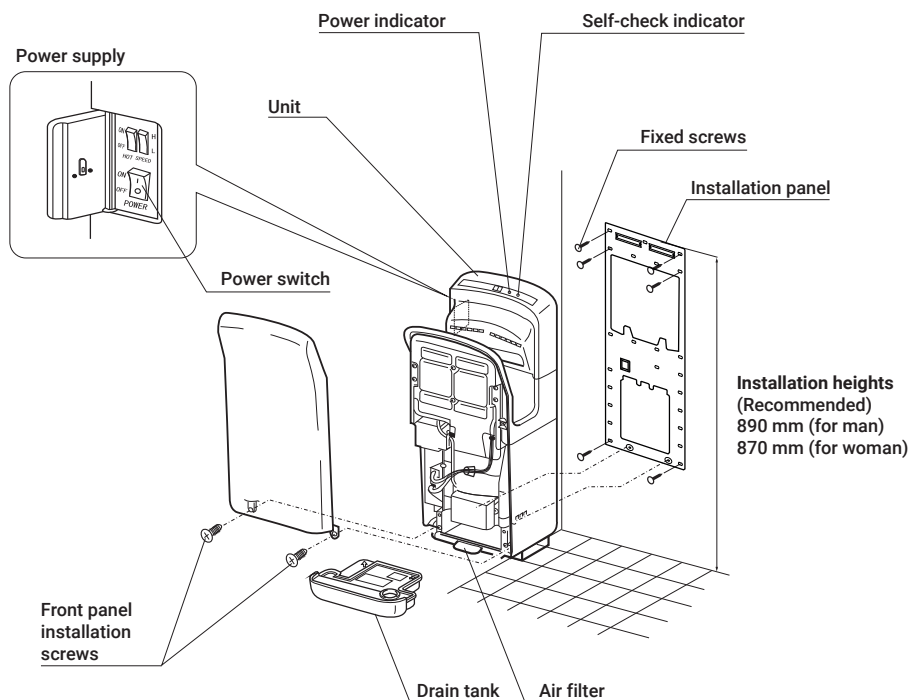

## Installed terminal box

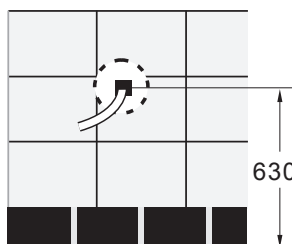

630mm

Distance between the terminal box without cover and the ground

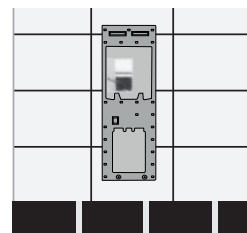

# Installation Procedures

- Use a single-phase alternating rated voltage supply. (Do not use with a power supply exceeding rated voltage  $\pm 10\%$ )
- Use a power cord which is between  $2\text{mm}^2$  and  $2.5\text{mm}^2$  thick. (Cords other than  $2\text{mm}^2$  -  $2.5\text{mm}^2$  single-core cords cannot be used.) A drop in voltage is possible if the power cord exceeds 11m in length.

## Part 1

### Wire the unit

Embed the switchbox in the installation location (1 switchbox no cover). Wire the power cord. If no switchbox is used, check the power cord is not be pushed out and will prevent the unit from being installed firmly against the wall.

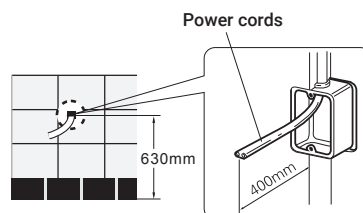

## Part 2

Attach the installation panel to the wall using the 6 installation screws.

- If the wall is concrete, use commercially available metal screw plugs (curl plugs, etc)
- If the wall is not concrete, reinforce it before installation.

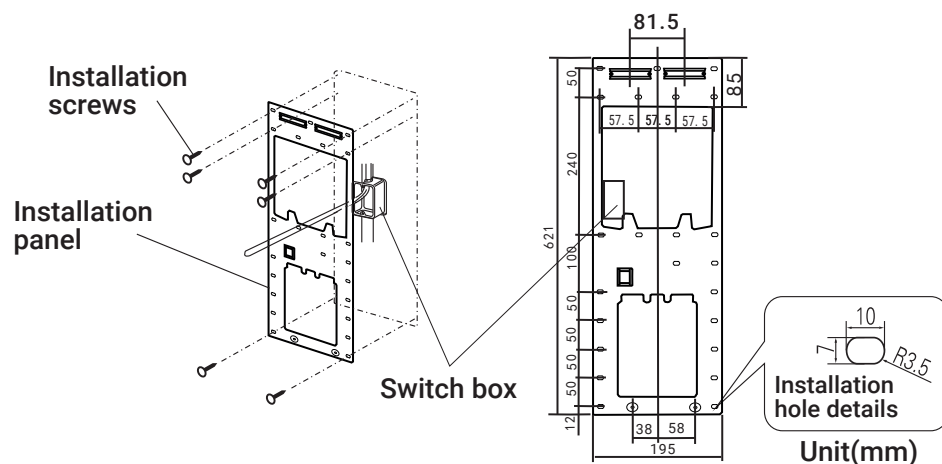

## Part 3

### 1. Remove the drain tank

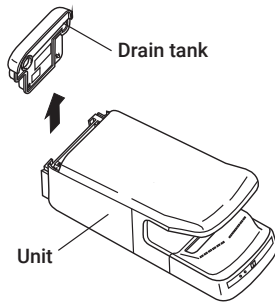

### 2. Remove the front panel

- Remove the two screws
- Remove all the front panel chuckholes (3).

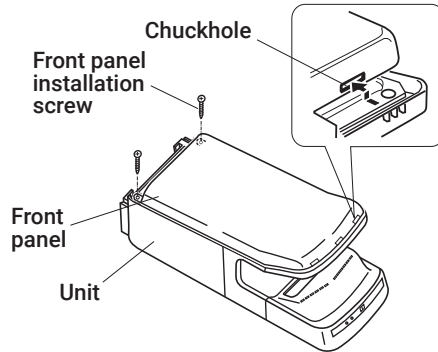

### 3. Remove the terminal box cover

- Remove the terminal box cover screw and pull the cover out towards you

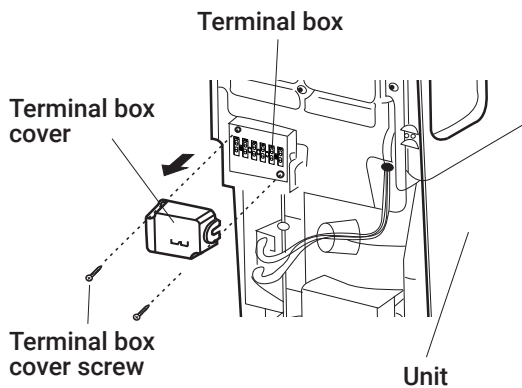

## Part 4

**Pull the separate line power cord into the unit and secure inside**

1. Pull the power cord through the rear of the unit, attach the rear side to the 2 hooks on the installation panel.
2. Ensure the unit is hooked onto the installation panel, tighten the safety screws (at the lower right).

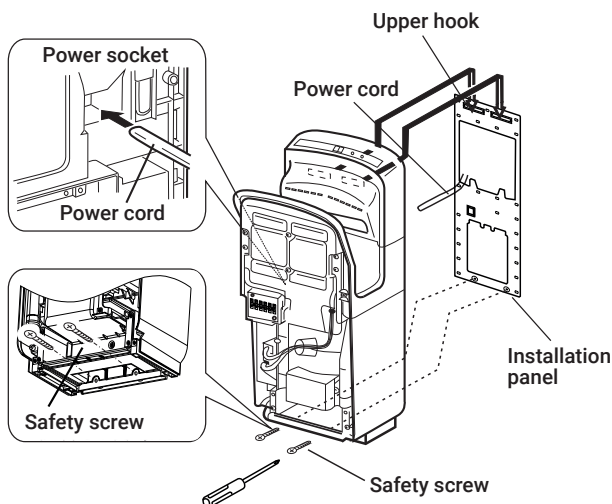

### Note

- The installation screws for the unit will not tighten completely if the hooks at the bottom of the installation panel are not in place.
- If you do not tighten the safety screws the unit may drop or be at greater risk of theft.

## Part 5

**Wire the terminal box. (There is no polarity.)**

1. Strip the wire sheath as shown in the figure at right
2. Loosen the screws on the terminal box and connect the power cord to the terminal box
3. Tighten the screws on the terminal box and pull the power cord to make sure it is firmly secured.
4. Bind the power cord using the clip to the right of the terminal box and fix it to its original location.

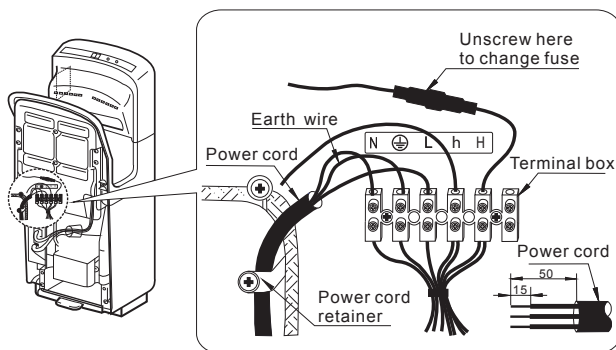

## Part 6

### Attach the terminal box cover.

1. Place the terminal box tabs into the holes and return the cover to its original position, securing it with the screw.
2. Make sure the power cord and other wires not pinched.
3. The front panel cannot be attached if there are any wires in front of the terminal box cover. Move the wire to the right of the terminal box cover.

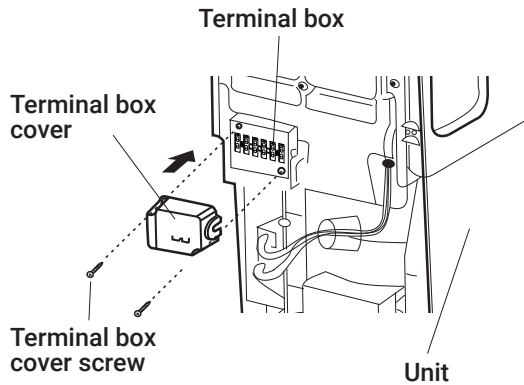

## Part 7

1. Attach the front panel
  - Insert the 3 front panel chuckholes into the unit
  - Replace the screws that were removed
2. Attach the drain tank
3. Make sure the air filter is all the way in

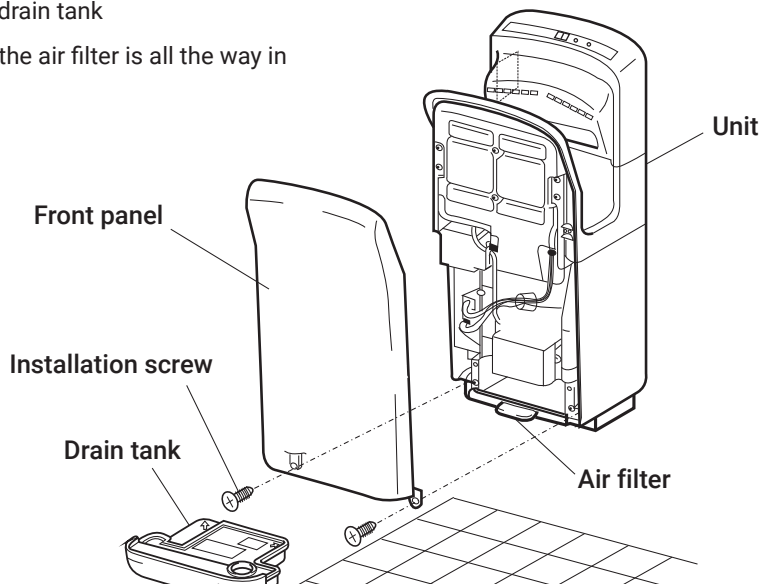

# Customer Service

- Repairs must be carried out by authorised specialists, thus ensuring electrical safety.
- Please contact with the service agent or a suitably qualified electrician.
- Improper repairs could lead to danger to the user.

Warranty does not cover damage of failure which results from alteration, accident, misuse, abuse, neglect, commercial use or improper maintenance. In line with our policy of continuous product development we reserve the right to change the product and documentation specifications without notice.

## Environmental Protection



In accordance with European Directive 2001/96/EG concerning used electrical and electronic appliances (waste electrical and electronic equipment – WEEE), please return any electrical equipment that you will no longer use to the collection points provided for their disposal.

This symbol indicates that the appliance cannot be treated as normal domestic trash, but must be handed to a collection point for recycling electric and electronic appliances.

Information concerning where the equipment can be disposed of can be obtained from your local authority.





**handydryers**

## **HandyDryers**

Unit 9, Stort Valley Industrial Estate  
Stansted Road, Bishop's Stortford  
Hertfordshire, United Kingdom  
CM23 2TU

**[www.handydryers.co.uk](http://www.handydryers.co.uk)**  
**01279 466500**  
**[info@handydryers.co.uk](mailto:info@handydryers.co.uk)**